

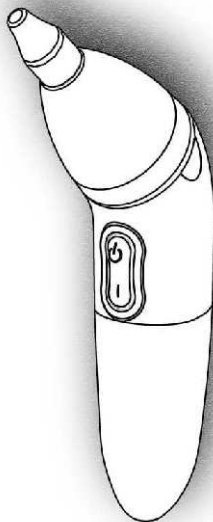

**Washable**  
**Electric Nasal-Aspirator for Children**

**Operating Instructions**



Please read the following instructions carefully before you start to use this electrical nasal aspirator.

- Convenient constant suction nasal aspiration anywhere-anytime.
- Clean and hygienic, clears noses in seconds and encourages good breathing habits.
- Washable and fully submersible for easy clean up and after-care.
- Light-weighted and ergonomically shaped.
- Clears mucus even from deeper nasal cavity.

## **Product Characteristics**

- Acts promptly, it takes only seconds to operate.
- Powerful on mucus, gentle on the nose.
- Moderately low noise.
- Handy, light-weighted and ergonomically shaped, easy-to-use continuous suction anywhere-anytime.
- Washable, water-resistant, the machine can be washed with water and the cup can be sterilized by boiling water or steam.
- Convenient, powered by battery, no charging needed, always on stand-by.
- Power saving, two No.3 alkaline-batteries for hundreds of operations (about 5-10 sec for each operation).
- Full 12 months warranty.

## **\*\* Safety Precautions \*\***

- This Product is designed to remove overflow nasal mucus. Do not use if for any other purpose.
- Before use, make sure that the silicon plastic nozzle is firmly mounted at the inlet end.
- The product should be restricted to personal use. Do not share the product with others as this may help to spread infectious diseases.
- The Product is designed for at-home use only. It should not be applied to any commercial or medical purpose.

## **Cautions**

1. Do not wash aspirator before the battery compartment lid is closed firmly. Wipe the case dry before you open the lid.
2. Do not remove any fixed screws or rubber parts, or you may damage the delicate water-resistant construction.
3. Do not wash and clean the product with thinner, benzene, or any solvent.
4. Stop using the product if it is damaged or deformed by severe strike or return it to SNOTTY if the product is faulty.

## Warnings

1. The product is designed for competent adult use only; any use by child himself is strictly inhibited.
2. Do not use the product on any purpose other than sucking the running snot of children.
3. It is strictly inhibited to place the nozzle at baby's nostril for a long time; a few seconds will be well enough to remove the snot.
4. Do not wedge the nozzle in the nostril; a touch with the outer side of the nostril will be enough for the machine to work well.
5. Do not use the product if there is any wound, or symptom of inflammation or bleeding in the nose or post ENT treatment.
6. Be sure to clean the product before and after use, referring to the section of <Cleaning of the machine>.
7. Store the product in a dry and cool place. Remove the batteries if the machine is to be idle for a long time.
8. The product is not to be used for medical purpose. If there should be any health related problem, please stop using the product right away and consult with a qualified physician.

## Part Names

- |                   |                           |
|-------------------|---------------------------|
| 1. Nozzle         | 8. Body                   |
| 2. Collection cup | 9. ON-button              |
| 3. Base plate     | 10. OFF-button            |
| 4. Base o-ring    | 11. Battery cover o-rings |
| 5. Air hole plug  | 12. Battery compartment   |
| 6. Plug o-ring    | 13. Battery cover         |
| 7. Outlet hole    |                           |

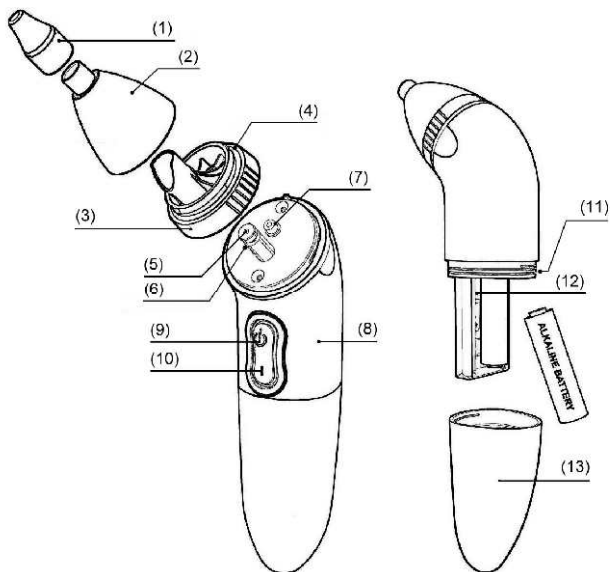

# Operating Instructions

Clean the component parts as described in section <Cleaning of the machine> before use.

## 1. Installing the battery

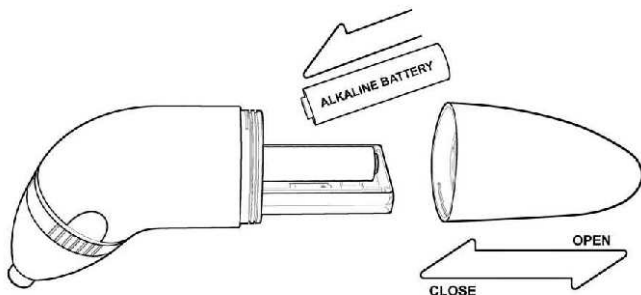

- (1) Remove the battery compartment lid. (Wipe the case to dry first if there is water remained.)
- (2) Insert two AA alkaline batteries with correct polarity.
- (3) Mount the battery compartment lid.

\* Remove the batteries if the machine is not used for a long time.

## 2. Removing and mounting the cup

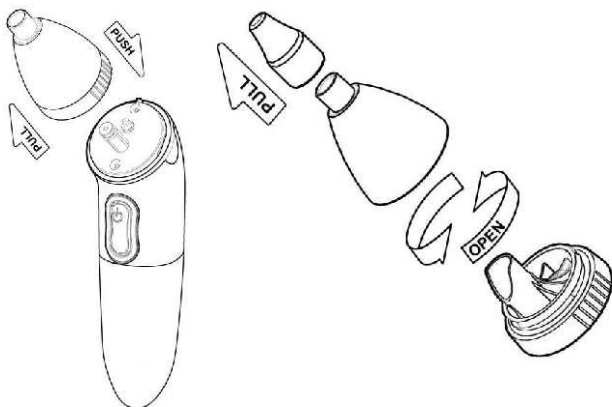

- (1) Lift the cup to remove it.
- (2) Lift the silicon plastic nozzle to remove it.
- (3) Turn the under-cover as indicated by the arrow to open it.
- (4) Reverse the above steps to mount the parts.

## 3. Power on/off

Press the upper side of the rubber button to turn on the power, or the under side to off.

#### **4. Using the aspirator**

- (1) Approx 1-2 min before aspiration spray saline solution up child's nostril to loosen up mucus and assist aspiration.
- (2) Turn on the power.
- (3) Place the nozzle at the outer side of your baby's nostril sealing it completely. Let aspirator operate for about 3-5 sec., and watch the mucus flow into the collecting chamber. Repeat in other nostril.
- (4) Clean the machine as described in section <Cleaning of the machine>.

### **Cleaning the machine**

**Remove the Cup as described in the <Operating Instructions> before you start to clean.**

#### **1. Cleaning the collection cup and nozzle**

- (1) Remove the collection cup, base plate and nozzle and clean them thoroughly with water.
- (2) Sterilize by boiling water or steam.



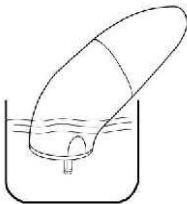

## **2. Washing the case and the inner pump**

- (1) Make sure that the battery compartment lid is closed firmly.
- (2) Remove the Cup.
- (3) Have the machine soaked into a pot of warm water. Turn on the power and the inner pump will be cleaned. (The rotation rate of the pump is 5,000 rotation/min, soaking for 5 sec will be well enough.)
- (4) Change the water and repeat the cleaning steps for several times if needed.
- (5) Clean the external of the case with water and neutral detergent
- (6) Wipe the case to dry with soft cloth.

## **Specifications**

**Power:** Two (2) no. 3 AA batteries (not supplied)

\*Alkaline batteries are recommended.

**Suction:** Approx. 50 kPa or 7.25 PSI

(may vary with battery power)

**Size:** 17.5 (L) x4 (W) x4.2 (H), cubic cm

**SNOTTY**

**PO Box 111**

**Labrador QLD 4215**

**[www.snotty.com.au](http://www.snotty.com.au)**

Feedback and customer service at:

[info@snotty.com.au](mailto:info@snotty.com.au)

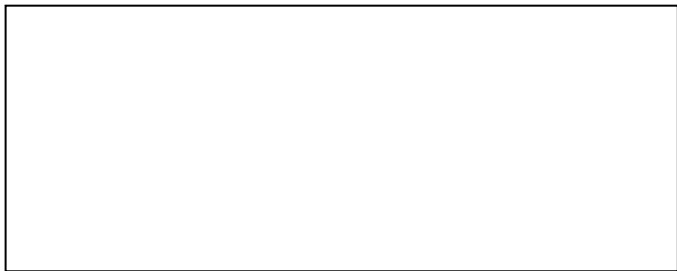

## Trouble shooting

PROBLEM	CAUSE	REMEDY
1. Aspirator not starting	Flat Battery	Replace batteries
	Wet Battery	Dry for 24h. & check battery cover o-rings (11)
	Batteries installed incorrectly	Install batteries properly
2. Low suction (at base plate (3) and the diagonally cut blue pipe)	Base plate not attached properly	Re-attach base plate (3)
	Plug o-ring not sealing	Adjust or replace plug o-ring (6)
3. Low suction (at collection cup tip – WITHOUT nozzle)	Collection cup not attached properly	Re-attach collection cup (2)
	Base o-ring not sealing	Adjust or replace base o-ring (4)
4. Low suction (at collection cup tip – WITH nozzle)	If nozzle is REMOVED and suction is same strength as at base plate diagonal cut blue pipe* (point 2 above)	The aspirator is functional. The small hole size at tip of nozzle reduces the suction sensation.
	If nozzle is REMOVED and suction is weak	Perform checks as per point 2 & 3 above.



is proud to offer Australian parents WORK FROM HOME opportunities with the goal of improving their financial situation while promoting children's health and welfare.

**The concept is simple:**

1. You purchase aspirators from us
2. You sell them; wholesale, retail, web sales or by hosting *SNOTTY* parties
3. ALL takings from sales are yours, earning as much as 300% on your investment

**Contact**

**workfromhome@snotty.com.au**