



INFORMATION SHEET #013

Trouble Shooting Chart – SNOTTY THREE

The below chart has been created to streamline trouble shooting procedures and enable better understanding of loss of suction/problems with SNOTTY THREE nasal aspirator.

PROBLEM	CAUSE	REMEDY
1. Aspirator not starting	Flat Battery	Replace batteries
	Wet Battery	Dry for 24h. & check lower cover o-rings
	Batteries installed incorrectly	Install batteries properly
2. Low suction (at nozzle tip)	Nozzle not attached properly	Re-attach nozzle (1)
	Collection cup o-ring not sealing properly	Check the two o-rings on blue collar plate (4)
3. Low suction (with nozzle off at open mucus cup (2))	Collection cup not attached properly	Check assembly of mucus cup (2)
	Base o-ring not sealing	Check collar plate o-rings (3)
	Aspirator has not been cleaned properly	Wash aspirator as per page 8 in the manual, cleaning the pump by submersion.
		If nozzle is REMOVED aspirator should suction on firmly

Part Names

1. Nozzle
2. Mucus Cup
3. O-rings
4. Collar
5. Button
6. Upper Cover
7. Lower Cover

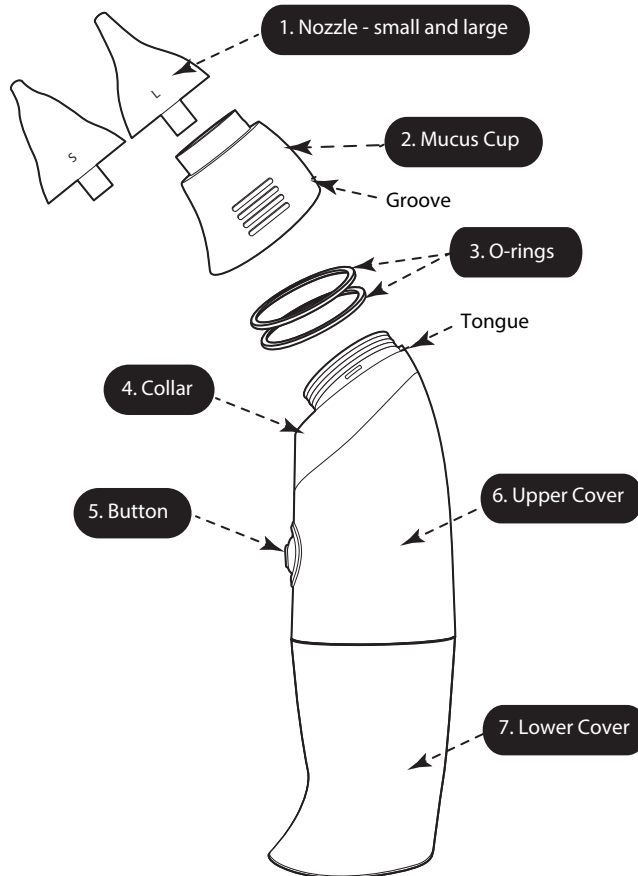

Note the important locations of the o-rings:

3. O-ring
7. Lower Cover

The **o-rings (3)** are the parts of the aspirator mostly susceptible to leakage through damage or inappropriate assembly.

Crucial assembly points are:

1. That o-rings (3) are not damaged or out of place
2. That the mucus cup (2) is fixed firmly onto the body of the aspirator, all the way down, touching the rim of the blue collar plate (4).
3. That the tongue and groove fits firmly together on top of collar (4) and mucus cup (2).
3. That the nozzle (1) is fixed firmly touching the rim of the clear mucus cup (2)

ACTION

Please feel free to print this or provide to clients via electronic means.

- END -